



THE SUNFLOWER

VOLUME XI, NUMBER 3 & 4

A Quarterly Publication

NOVEMBER-FEBRUARY 1989-90

. . . IN THIS ISSUE

- | | |
|-------|--|
| 23-24 | Early History of Sylvania, KS
by Arless MOSER EILERTS |
| 25 | 1902 Plat Map of Sylvania Township |
| 26 | Sylvania City Map |
| 27-28 | Sylvania City Directory |
| 29-30 | Sylvania Business Directory |
| 31-33 | R. L. Polk Gazetteer Business
Directory 1882-3 |
| 34 | Mary MC CAFFERY Story |
| 36-37 | News from the Past
submitted by Delma KINCHLOE ASHCRAFT |
| 38-39 | Turon High School Graduates |

**RENO COUNTY GENEALOGICAL SOCIETY
OFFICERS FOR 1990-91**

PRESIDENT		
Karen (POULTON) BURGESS		662-6106
VICE-PRESIDENT		
Ruth (HAIR) FILBERT		663-2804
RECORDING SECRETARY		
Barbara (HAMBY) MURPHY		662-8549
CORRESPONDING SECRETARY		
Edgar GROVER		669-9485
TREASURER		
Roy GARDNER		662-8192
IMMEDIATE PAST PRESIDENT		
Karen (POULTON) BURGESS		662-6106
QUARTERLY EDITORS		
Pam (THOMPSON) STANSEL		663-8678
Ruth (HAIR) FILBERT		663-2804

STANDING COMMITTEE CHAIRPERSONS

CONSULTANT		
Malinda (CROTTS) PETERSON		663-3453
EDUCATION		
Ruth (HAIR) FILBERT		663-2804
HISTORIAN		
Harriet (HELMICK) CUSHING		662-0738
LIBRARIAN		
Lyida (HEWITT) STREETER		662-1103
MEMBERSHIP		
Paula (KIDD) NELSON		
OBITUARY		
Alta (ENGLER) PROCTOR		665-5966
PROGRAM		
Ruth (HAIR) FILBERT		663-2804
PUBLICITY		
Barbara (HAMBY) MURPHY		662-8549
RESEARCH		
Karen (POULTON) BURGESS		662-6106
SALES (FORMS), WAYS & MEANS		
Lynn & Pam (THOMPSON) STANSEL		663-8678
SPECIAL ACCOUNT TREASURER		
Roy GARDNER		662-8192
SURNAME FILE		
Carrolyn (BURDETTE) MILLER		669-9757
WHO'S NEW		
Opal (MATLACK) CULVER		665-6204

The Co-Editors of **THE SUNFLOWER** would like to give new members a chance to purchase back issues, Volume I - X plus the Special Charter issue. This is the time to replace missing issues, too. \$5.00 per volume - \$1.25 per issue. Add 50¢ per issue postage & handling. Kansas residents add 5.75% tax to total. RHF

Have you purchased your copy of the 1880 Federal Census for Reno County, Kansas? Over 14,000 names alphabetically listed, compiled by members of The Reno County Genealogical Society. \$15.00 plus \$1.50 postage and handling. Kansas residents add 90¢ sales tax.

The Reno County Genealogical Society is publishing Books I, II & III and IV (Register of Funerals): Vital Records of Reno County - Deaths 1890 - 1907. Watch for publication date in later issues.

BITS AND PIECES

In memory of Someone Else

We were saddened to learn this week of the death of one of the organization's most valuable members, Someone Else. Someone's passing created a vacancy that will be difficult to fill.

Else had been with us for many years. Someone did far more than a normal person's share of work. Whenever leadership was mentioned, this wonderful person was looked to for inspiration as well as results.

"Someone Else can work that group." Whenever there was a job to do, a committee to chair, or meeting to attend, one name on everyone's list: "Let Someone Else do it."

Someone Else was a wonderful person, sometimes appearing superhuman, but a person can do only so much. Were the truth known, everyone expected too much of Someone Else. Now Someone Else is gone! We wonder what we are going to do. Someone Else left a wonderful example to follow, but who is going to follow it? Who is going to do the things Someone Else did? When you have a chance to participate in your own organization, remember: We can't depend on Someone Else anymore!--Author Unknown (Source: Iowa Genealogical Society Newsletter. Submitted by Bert NEWTON.)

Early History of Sylvania . . .

by Arless Moser Eilerts

(Author's note: Information for this article comes from Sylvia, Kansas 1887-1987, Published by the Centennial Committee, Donna Graber, chairman; History Book Committee, Mary Ellen Roberts, chairman.)

In 1987, Sylvania, Kansas, held its centennial celebration, dedicating its centennial publication to "Uncle" Henry Thompson, who in 1885 formed the town company to build the town.

Thompson was born 13 Jan 1851 in Louisville, KY, and came to Kansas in 1882. He secured Sylvania's future when he got the Kinsley branch of the Atchison, Topeka, and the Santa Fe Railroad surveyed through the town.

He married Mary Shepherd, a native of Ohio, on 13 Jun 1885. The Thompsons had no children, but reared their niece, Grace Shepherd.

Few inhabitants before 1870

In western Reno County, as in other areas of the county, there were very few people prior to 1870. The few Indians were either Wichitas or Comanches. Even Coronado was not recorded as having explored in the area which lies south of the great bend of the Arkansas River.

In 1819-20, Major Stephen H. Long mapped the Kansas area and called it the Great American Desert. Visitors were infrequent until the late 1860s when buffalo hides became a commercially profitable venture. It has been estimated that by the summer of 1872, in the portion of Kansas west of Wichita and south of the Arkansas River, 2,000 were shooting buffalo for their hides.

First area homesteaders

The first homesteaders in the area seem to have been the Missouri contingent who settled about 22 miles south of Sterling in an area they called Peace Creek. Among the group were James Byron (Bite) Clothier, Wid Clothier, Henry Wilhite, Doc Steward, and Chauncy Clothier (a Church of Christ minister). When prairie fires burned out nine of the Peace Creek settlers (including J. B. Clothier), they resettled further south, coming into Reno County.

In the 1870s Sylvania was just a sand mound, 300 yards in circumference, located on the Thompson Ranch. Still present were the signs indicating where men had lain to shoot buffalo.

Sylvia and the Railroad

The state of Kansas deeded the land where Sylvania is located to the AT&SF Railway Co. in 1884. On 27 May 1886 (1885?) the land was deeded by warranty deed to M.T. Ewing and H.S. Thompson. On 26 March 1886 the land was deeded to H.S. Thompson and his wife, Mary. The deed was immediately transferred to the Sylvania Town Company. On 7 April 1886, the town company platted the town of Sylvania and made it a matter of record at the Reno County courthouse.

Incorporation and naming

Sylvia was incorporated as a city of the third class less than a year later. A.A. Robinson, a vice president of the Santa Fe railroad, named the town Sylvania, in honor of his wife. Thompson insisted on the name of the town being Zenith in honor of the local Star Route post office which was located where the Leo Staats family lived in 1986. A compromise was reached when Robinson agreed to put in a station five miles west and call it Zenith.

Growth

When less than two months old, Sylvania was reported by a newspaper to have two elevators, three lumber yards, a bank, a livery stable, a hotel, and a newspaper. The Weekly Telephone, published Sept. 7, 1886, stated Sylvania had a population of 200 and more were still coming.

Sylvia was reported to have the best water wells around, nestled, as it was, in the valley of the North Ninnescah River. Soft, cold water was obtained by driving only 15 to 20 feet. The first windmill in Sylvania Township was located one-half mile north of Carl Hudson's farm. The soil was sandy loam, well adapted to corn, wheat, oats, potatoes, and tame grasses.

Main Street was pure sand one foot deep. The sidewalks were board, four feet wide and elevated. Brick sidewalks were put in in the early 1900s. Trees sprouted along

the business and residence streets, thanks to local residents who set out maples, catalpas, cedars, and elms.

Early stores

Early stores were a grocery run by Tom Talbot, a dry goods store owned by Tom Holley, the millinery store of Mrs. A.L. Nelson, a lumber yard and an elevator owned by Frank Austin, the State Bank by A.N. Bontz, and two saloons.

Fires often plagued the town. In February of 1910, an entire block on the west side of the street was wiped out; five buildings burned. A large bucket brigade was able to save only the buildings on the east side of the street. Two years later, another fire broke out during a blizzard, starting in the City Market and spreading to the Citizen State Bank and the Congregational Church.

Street names*

Plevna Street, named for a town in Bulgaria, was also the name given to the town just east of Sylvania, located at Hayes Crossing and later moved to its present site. The newspaper at the time reported daily on a siege at Plevna, Bulgaria (Bulgarian spelling of Plevna), which lasted about four months. The Turks were driven from Bulgaria by the Russian army.

Shepherd Street was named for Nathan and Lucinda Shepherd, from Newcomerstown, Ohio, who first lived in the home on the Minnescah Ranch, later purchased by Henry S. Thompson. Nathan then managed the ranch for Thompson. When the Shepherds moved to Sylvania, they lived in the second house from the north end of Plevna Street. Henry married Mary Shepherd, one of Nathan and Lucinda Shepherd's daughters.

Thompson Street was named for the uncle of Henry S. Thompson, with Thompson and Company of Louisville, KY., who furnished finances for Henry's Kansas venture.

Talbot Street was in honor of Thomas J. Talbot, an early postmaster at the old Zenith post office, and James M. Talbot, the first mayor of Sylvania.

Stafford Street was named for Capt. Lewis Stafford, a Civil War soldier from Kansas killed at the battle of Young's Point.

Post offices

The first post office was Zenith, started 12 May 1886, with Thomas J. Anderson as the first postmaster. Mail arrived once a week by Star Route. John Brem, the first contractor for the route, received \$286 yearly for the 41-mile weekly trip.

When Sylvania was officially designated in 1887. H.S. Austin was appointed the first postmaster. The mail came daily by train. Early postmasters were Tom Litchfield, J.A. Whitehurst, C. Tipton, E. Smith, Amanda Baird, Frank Forney, J.E. Aldrich, L.G. Waggoner, and John Coleman.

Banks

The first bank in Sylvania was a disastrous failure in 1897. The rumor was that an irate depositor threatened to kill A.N. Bontz, the banker. Bontz moved to Wichita where he became a prominent businessman. The State Bank of Sylvania was established in 1898 with \$5,000 capital. W.H. Hinshaw was the president and O.G. Hinshaw the first cashier.

The Citizens State Bank was organized on 5 Feb. 1909. O.C. Lang was its first president and F.E. Lang its first cashier. Its original capital was \$10,000. Several years later the two merged. The bank then sold out to Ed Peterson of Kansas City, closing in 1932 when the Depression hit.

Sylvania Depot

The Sylvania depot, originally built on the north side of the tracks with a Mr. Gray as the first depot agent, was demolished in a train wreck. A large depot was then built across the tracks on the south side. Thompson followed up on a citizen demand for a larger and more modern building, persuading the Santa Fe officials to build a larger depot. Built of brick, it was completed in 1914. The building was dismantled in 1986.

*(From "Where Our Streets Got Their Names" by Maxine Gastin Geist.)



PLAT OF

SYLVIA

Scale 2 Inches to the Mile. Township 24 South. Range 10 West. of the 6th Principal Meridian.

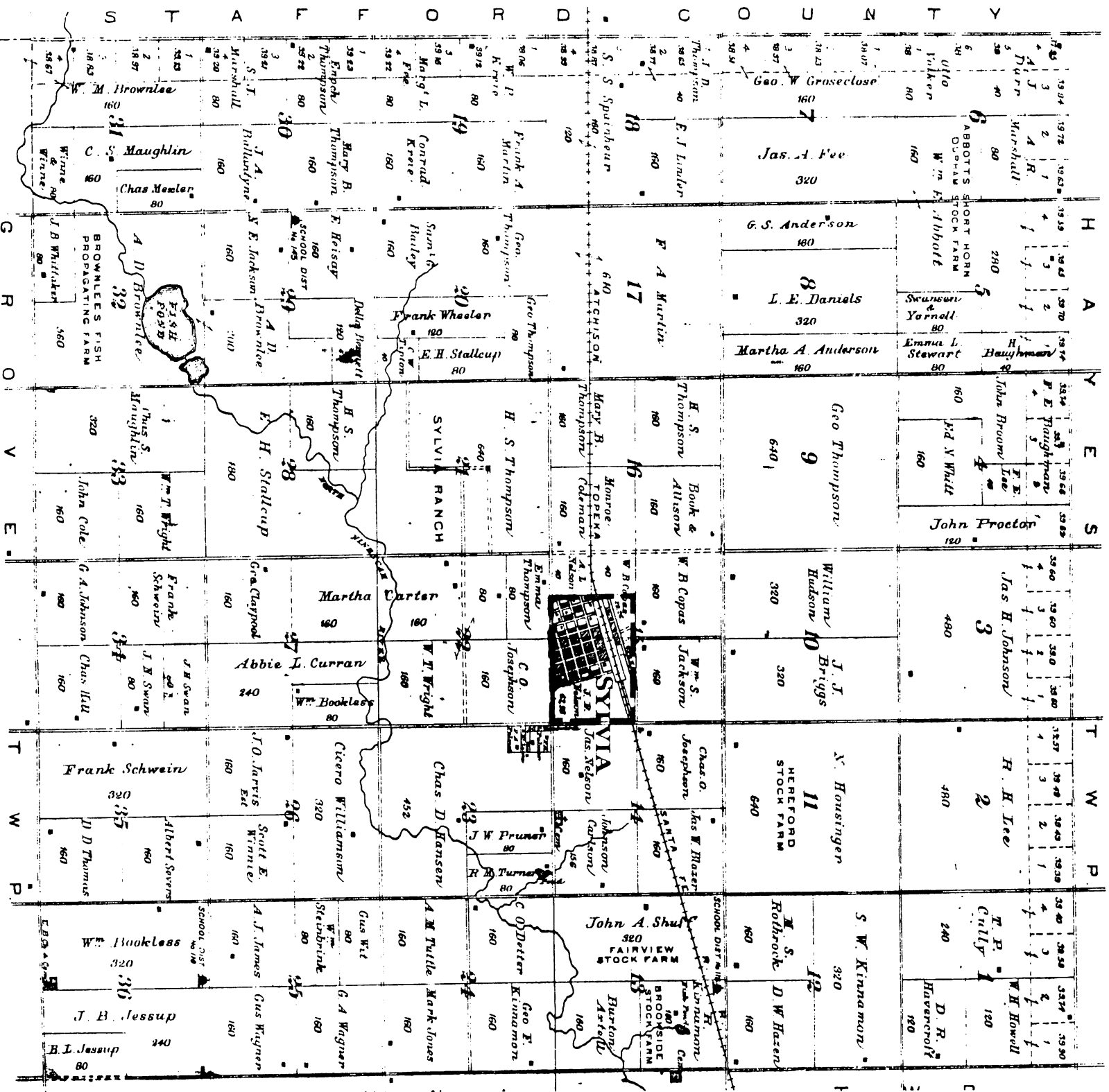

SYLVIA

SYLVIA TWP.

Scale 300 ft. to one inch.



Sylvia City Directory

A

Austin, H.S., manager, Sylvia Furniture Co., residence Mardis St. between Ave. D & E.

B

Ball, J.M., assistant foreman at cattle ranch, residence Mardis St. between Ave. E & F.

Bartelson, James, section foreman, boards at the Imperial Hotel.

Barton, Mr. & Mrs. John, (Hott & Barton,) residence Shepherd St. between Ave. D & E.

Benedict, W.H.S. (Talbott & Benedict,) residence Shepherd St. between Ave. D & E.

Bills, D.C. physician, office at Gillespie's drug store, residence corner of Mardis St. & Ave. F.

Bird, Henry, billiard (sic) hall, boards Imperial House.

Birch, Wm., proprietor of Imperial House.

Blum & Weigner, (Henry Blum and _____ Weigner,) general merchandise, corner Main St. & Ave. D.

Blum, Henry, (Blum & Weigner,) residence corner Thompson St. and Ave. D.

Bontz, A.M., cashier Bank of Sylvia, residence Mardis St. and (sic) Ave. C & D. (Note: "and" should probably be "between".)

Bonford, Henry, (McLane & Bonford,) residence corner of Mardis St. & Ave. C.

C

Campbell, Miss Minnie, cook at Imperial House.

City Meat Market, J.A. Fickertt, proprietor, corner Main St. and Ave. C.

Curran, Chas., assistant postmaster, residence corner of Mardis St. and Ave. D.

E

Ellis, Wm., plasterer, boards at the Imperial Hotel.

Evans, John D., editor of Sylvia Telephone, boards at the Imperial House.

F

Fair, Shaak and Co., B.B. Willson, manager, Main St., south of railroad.

Fell & Roberts, (J.P. Fell, James Roberts,) Livery, feed and sale stable, corner of Ave. C and Thompson St.

Fickertt, J.A., proprietor of City Meat Market, residence corner of Thompson St. & Ave. C.

G

Gillespie, J.M., druggist, store Main St. between Ave. C & D, residence corner of Mardis St. and Ave. F.

Good, Albert, section hand, boards at the Imperial House.

Granville, Fred, carpenter, boards at the corner of Thompson St. & Railroad Ave.

Gray, Chas., station agent, residence Mardis St. between Ave. D & E.

H

Harrison, Wm. H., Harness, shop Main St. between Ave. C & D.

Hawley, T.J., general merchandise, store between Ave. C & D, residence corner of Mardis St. & Ave. D.

Hemlig, J.B., carpenter, residence Thompson St. between Ave. C & D.

Hill, N., works for Fair, Shaak & Co., residence Main St. between Ave. D & E.

Hotel de Horse, Turner & Miller, proprietors, livery, feed and sale stable, corner of Thompson St. and Ave. C.

Hott & Barton, (John Hott & John Barton,) furniture, store Main St. between Ave. C & D.

Hott, John, (Hott & Barton,) residence Main St. between Ave. C & D.

Hott & Barton, (Mrs. John Hott, Mrs. John Barton,) Millinery and dressmaking, Main St. between Ave. C & D.

Hott, Ernest, clerk for Triplett, residence Shepherd St. between Ave. D & E.

Hurd's Art Gallery, (Hurd & Son,) between railroad and Ave. C.

Hurd, _____, (Hurd & Son,) boards at Turner House.

Hurd, Fred, (Hurd & Son,) boards at the Turner House and Ave. C.

I

Imperial House, Wm. Birch, proprietor, corner of Main St. and Ave. C.

J

Jones, John, boards at the Imperial House.

Josephson, John, hosteler, boards corner of Shepherd St. and Ave. C.

Josephson, Gus, farmer, residence corner of Reno St. and Ave. C.

K

Kahn & Vendig, (A. Kahn, Samuel Vendig,) general merchandise and stock dealers, store Main St. between Ave. C & D.

Kahn, A., (Kahn & Vendig,) residence over store, Main St. between Ave. C & D.

Kahn, Julius, clerk for Kahn & Vendig, residence over store, Main St. between Ave. C & D.

Kansas Grain & Live Stock Co., G.E. Willison, manager, Main St. between railroad and Ave. C.

Kitchen, Emma, works at Turner House.

L

Lee, J.H., barber shop, Main St. between Ave. C & D, residence corner of Thompson St. and Ave. C.

Litchfield, Lewis, works for F. McCullam & Co., boards at corner of Shepherd St. and Ave. E.

Littlefield, F.O., works for Fair, Shaak & Co., residence Main St. near railroad.

Lottridge, M., physician, office Main St. between Ave. C & D, residence between Ave. C & D.

M

Mackey, John, Hosteler, boards at the Turner House.

Mardis, G.W., painter, residence Mardis St. between Ave. C & D.

May & Bower, (J.B. May, Jeff Bower,) real estate, loan and insurance, Main St. between Ave. C & D.

May, J.B., (May & Bower,) residence Thompson St. between Ave. D & E.

McCullam, F. & Co., G.E. Willison, manager, Main St. between railroad and Ave. C.

McDonald, plasterer, boards at the Turner House.

McLane & Boufoud (sic) (John McLane, Henry Bouford,) grocers, store Main St. between Ave. C & D.

McLane, John, (McLane & Bouford,) residence corner Mardis St. & Ave. C.

N

Norris, B.C., confectionary and lunch counter, store and residence Main St. second door from Ave. C.

P

Palmer, A.W., Fuel foreman and pump engineer on the C.K. & W. railroad, residence east of the south line of town.

Parish, J.W., residence Thompson St. between Ave. C & D.

Payton, C.A., manager of Sylvia Telephone, residence Shepherd St. between Ave. D & E.

Post, J., carpenter, boards corner Mardis St. and Ave. D.

R

Richards, C.M., agent for Miller & Turner, boards at the Turner House.

Roberts, James, (Fell & Roberts,) residence corner Shepherd St. & Ave. C.

S

Shepherd, N.H., & Co., (N.H. Shepherd & J.M. Shepherd,) agricultural implements, hardware and stoves, store corner Main St. & Ave. D.

Shepherd, N.H., (N.H. Shepherd & Co.,) residence corner Reno St. and Ave. C.

Shepherd, J.M., (N.H. Shepherd & Co.,) residence Mardis St. between Ave. C & D.

Shepherd, H.T., Clerk, boards corner Mardis St. and Ave. D.

Smith, E.H., clerk, boards corner Mardis St. and Ave. D.

Stallcup, F., clerk at Bank of Sylvia, boards Mardis St. between Ave. C & D.

Stearns, Wm., farmer, residence Mardis St. between Ave. D & E.

Stewart, J.W., grader on railroad, residence corner Mardis St. and Ave. D.

Switzer, W., plasterer, boards at the Turner House.

Sylvia Furniture Co., H.S. Austin, manager, Main St. between Ave. D & E.

Sylvia Telephone, John D. Evans, editor, Chas. A. Payton, manager, office Main St. near corner of Ave. C, up-stairs.

T

Talbott & Benedict, (J.M. Talbott, W.H.S. Benedict,) real estate, loan and insurance, grain dealers, office Main St. near Ave. C.

Talbott, J.M., (Talbott & Benedict,) residence Thompson St. between Ave. C & D.

Talbott, J.C., residence Thompson St. between Ave. D & E.

Talbott, druggist and post master, store between Ave. D & E.

Thompson, Wm., contractor and builder, residence corner of Mardis St. & Ave. E.

Tomlinson, W.M., clerk at Imperial House.

Triplett, H.L., music store and agricultural implements, Main St. between Ave. C & D, residence Shepherd St. between Ave. D & E.

Turner & Miller, Robert M. Turner, _____ Miller,) proprietors of Hotel de Horse, corner of Thompson St. and Ave. C.

Turner, Robert M., (Turner & Miller) residence Turner House, corner of Thompson St. and Railroad Ave.

Turner House, Robert M. Turner, proprietor, corner of Thompson St. and Railroad Ave.

Turner, Wm., shoemaker, shop Main St. between Ave. C & D.

U

Underwood, F.L., carpenter, boards at the corner of Shepherd St. & Ave. C.

V

Vendig, Samuel, (Kahn & Vendig,) residence over store, Main St. between Ave. C & D.

W

Waters, Lou, waitress at the Imperial House.

Watson, J.F., agent for J.P. Fell, residence Mardis St. between Ave. E & F.

Weigner, _____, (Blum & Weigner,) residence _____.

White, H.K., pastor of the Presbyterian Church, boards at the Imperial House.

Willison, G.E., manager for F. McCullam & Co., lumber yard, residence Shepherd St. between Ave. D & E.

Willson, B.B., manager Fair, Shaak & Co.'s lumber yard, residence corner of Thompson St. and Ave. D.

Willson, J., assessor, residence Thompson St. between Ave. D & E.

SYLVIA BUSINESS DIRECTORY

Agricultural Implements

Shepherd, N.A., & Co., corner Main St. & Ave. D.

Triplet, H.L., Main St. between Ave. C & D.

Bank
Bank of Sylvania, W.O. Van Arsdale, president; A.N. Bontz, cashier, corner Main St. & Ave. D.

Barber Shop

Lee, J.H., Main St. between Ave. C & D.

Billard (sic) Hall

Bird, Henry, Main St. between Railroad Ave. & Ave. C.

Blacksmiths

Hawkins, E.L., Ave. C between Main & Thompson St.

Boot and Shoe Dealers

Blum & Weigner, corner Main St. & Ave. D.

Hawley, T.J., Main St. between Ave. C & D.

Agricultural Implements

Kahn & Vendig, Main St. between Ave. C & D.

McLane & Bonford, Main St. between Ave. C & D.

Turner, Wm., Main St. Between Ave. C & D.

Carpenters and Builders

Helmig, J.V., Ave. C, between Main and Thompson St.

Thompson, Wm., corner Mardis St. and Ave. E

Church Society

Presbyterian, W. K. White, Pastor

Coal Dealers

Talbott & Benedict, Main St. near corner of Ave. C.

Confectionery and Bakery

Morris, B.C., Main St. near corner of Ave. C.

Dressmakers

Hott & Barton, Main St. between Ave. C & D.

Drug Stores

Gillespie, J.M., Main St. between Ave. C & D

Talbott, T.J., Main St. between Ave. C & D.

Dry Goods

Hawley, J.T., Main St. between Ave. C & D.

Kahn & Vendig, Main St. between Ave. C & D.

Blum & Weigner, corner of Main St. & Ave. D

Furniture and Undertakers

Hott & Barton, Main St. between Ave. C & D.

Sylvia Furniture Co., H.S. Austin, manager, Main St. between Ave. C & D.

General Merchandise

Blum & Weigner, corner of Main St. & Ave. D

Hawley, T.J., Main St. between Ave. C & D.

Kahn & Vendig, Main St. between Ave. C & D.

Grain Dealers

Kansas Grain and Live Stock Co., G.E. Willison, manager, Main St. between the railroad and Ave. C.

Talbott & Benedict, Main St. between Ave. C & D.

Groceries

Blum & Weigner, corner of Main St. & Ave. D
Hawley, T.J., Main St. between Ave. C & D.
McLane & Bonford, Main St. between Ave. C&D

Hall

Sylvia Hall, over Bank of Sylvia, corner Main St. and Ave. D.

Hardware, Stoves, etc.

Shepherd, N.J., & Co. , corner Main St. & Ave. D.

Hawley, T.J., Main St. between Ave. C & D.

Harness and Saddlery

Harrison, W.H., Main St. between Ave. C&D.

Hotels

Imperial House, Wm. Birch, proprietor, corner of Main St. & Ave. C.

Turner House, Robert M. Turner, proprietor, corner of Thompson St. and Railroad Ave.

Livery, Feed and Sale Stables

Fell & Roberts, corner of Thompson St. & Ave. C.

Hotel de Horse, Turner and Miller, corner of Thompson St. and Ave. C.

Lumber Yards

Fair, Shaak & Co., B.B. Willison, manager, Main St. south of the railroad.

McCullam, F., & Co., G.E. Willison, manager, Main St. between the railroad and Ave. C.

Meat Market

City Meat Market, J.A. Fickertt, proprietor, corner of Main St. & Ave. C.

Millinery

Hott & Barton, Main St. between Ave. C & D.

Music Instruments

Triplett, Mrs. H.L., Shepherd St. between Ave. C & D.

Newspapers

Sylvia Telephone, The, John D. Evans, editor, Chas. A. Payton, manager, office Main St. over Talbott & Benedict's.

Western Home, The, May & Bowers, editors, published by Sylvia Telephone.

Physicians

Bilk, W.C., office Gillespie's drug store.
Lottridge, M., Main St. between Ave. C & D.

Photographer

Hurd's Art Gallery, Main St. between Ave. C & Railroad Ave.

Pumps and Windmills

Harrison, W.H., Main St. between Ave. C&D.

Real Estate, Loan and Insurance

May & Bower, Main St. between Ave. C & D.

Talbott & Benedict, Main St. near Ave. C.

School House

Stafford St. between Ave. C & D.

Stock Dealers

Kansas Grain and Live Stock Co., G.E. Willison, manager, Main St. between Ave. C & Railroad Ave.

Kahn & Vendig, Main St. between Ave. C & D.

The Serendipity Genealogist

by Arless MOSER EILERTS

One of the hazards of growing old--so I have been told--is slowing down. I'm becoming convinced it is true.

When I was a youngster. I could keep a dozen projects going at once. By shifting my energies from one to the other. I could stay fresh and maintain a high level of motivation. Of course. I had no patience with the "slowness" of old people.

As I get older. I have decided that slowing down may well be a blessing instead of a hazard.

One reason I become slower is an increased tendency to go off on side trails. I once accomplished more because I was single-minded on my tasks. I shudder now to think how much I may have missed by such immature thinking.

Taking side trails is particularly appropriate in family research. Although I still try to plan ahead to make the best use of the time I have available for genealogy. I have learned to build in some time to allow me to wander a bit from the plan.

Several times my going off on a side trail has produced astonishing results--what I call serendipity genealogy. I tied my paternal line to my first immigrant because I took time to look at the deeds on either side of the one I had traveled to Schuylkill County (Pennsylvania) to examine.

A second problem that has come with age is not so fortuitous--a mental slowing down. I can no longer remember all the genealogical data that I was once able to store without effort. Partially (maybe even mostly). I think I am a victim of overload instead of deterioration.

When I first started this addiction. there wasn't much to remember. but as I added families and complete lines to my knowledge I grew to resemble a computer in overload mode. When my computer gets an overload. It is necessary to clean out some files. printing hard copies of those I need to save.

I can prevent genealogical overload by recording the data in a form to which I can refer when I need it instead of having to remember everything. Another advantage of recording everything is that I can periodically review my files. including the one that holds all my fleeting thoughts of things to do next.

Getting older has also meant that I can no longer take a prolonged break and jump right back into a productive groove when I next get time to work. The transition requires me to review the last material I was working on to get the feel. the mood. and the ideas flowing again. However. doing this has often given new insights into material that I was too near before.

The nice thing about getting older is that being slow no longer frustrates me as it did when I was younger. I know that if I go a little more slowly now I make up for it by the depth of appreciation I have for the smaller things. and I certainly compensate by having the opportunity to explore more of those profitable side trails. Proof once again that given time and not too much anxiety on my part. things have a way of balancing themselves--often without my intervention.

Established 1878.

Refitted and Refurnished.

HOWARD HOUSE.

D. W. STIMMEL, Proprietor.

One Block South East Depot,
HUTCHINSON, KAN.

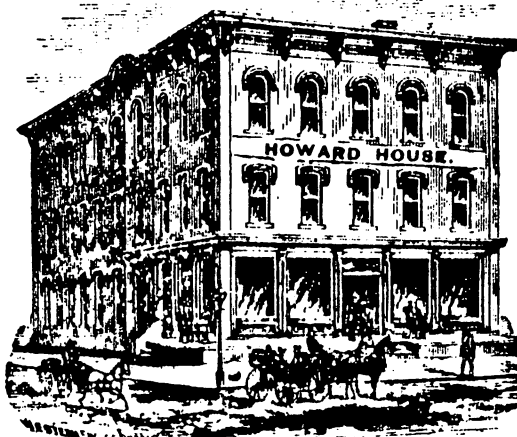

CENTRALLY LOCATED.

R. L. POLK & CO.'S

Kansas State Gazetteer

AND

BUSINESS DIRECTORY

FOR

1882-3.

In the following section of the work the cities, villages and postoffices of Kansas are arranged in alphabetical order, and a description is given of each place, with an alphabetical list of all persons doing business therein. In all the larger places the names have been procured by personal canvass, but in the smaller they have been furnished by postmasters. Great care has been taken to insure correctness, as well as completeness.

Abbreviations of Railroads in Kansas.

- | | |
|--|---|
| <p>A, T & S F R R—Atchison, Topeka & Santa Fe.
H br—Howard branch.
C & A C br—Caldwell & Arkansas City branch.
P H br—Pleasant Hill branch.
M & McP br—Marion & McPherson branch.
E br—Eldorado branch.
B & M R R R—Burlington & Missouri River.
K C R R—Kansas Central.
K C, F S & G R R—Kansas City, Fort Scott & Gulf.
R H br—Rich Hill branch.
P br—Parsons branch.
K C & S Line—Kansas City & Springfield.
K C, L & S K R R—Kansas City, Lawrence & Southern Kansas.
B br—Burlington branch.
C br—Coffeyville branch.
H br—Hunnewell branch.
M, A & B Ry—Manhattan, Alma & Burlington.
M P Ry—Missouri Pacific.</p> | <p>K & A div—Kansas & Arizona division.
K & T div—Kansas & Texas division.
N sec—Neosho section.
O B div—Central Branch division.
J br—Jewell branch.
R V br—Republican Valley branch.
S S sec—South Solomon section.
W br—Washington branch.
St L, F S & W R R—St Louis, Fort Scott & Wichita.
St L & S F Ry—St Louis & San Francisco.
K div—Kansas division.
G br—Girard branch.
J br—Joplin branch.
U P Ry—Union Pacific.
K div—Kansas division.
K C div—Kansas Central division.
St J & W div—St Joseph & Western division.
L br—Leavenworth branch.
S br—Solomon branch.
J C & Ft K br—Junction City & Fort Kearney branch.
McP br—McPherson branch.
C br—Carbondale branch.</p> |
|--|---|

HUTCHINSON. An incorporated city with a population of 2,500, is the county seat of Reno county, and is situated on Cow Creek, near the Arkansas river, in the north-eastern part of the county. It is a station and important shipping point on the A., T. & S. F. R. R., 218 miles from Atchison, 168 from Topeka, and 234 from Kansas City, Mo. It contains Methodist, Presbyterian, Catholic and Baptist churches, a good public school building, a brick court house, 2 banks, 3 weekly newspapers, the *Interior*, the *Herald*, and the *News*, a grain elevator, several flour mills, hotels, etc. A large quantity of railroad lands are for sale in this county, at from \$4 to \$8 per acre. Live stock, grain and flour are the chief shipments. Tel., W. U. Exp., Adams. Mail, daily. Hiram Raff, postmaster.

Atkinson W T, county treasurer.
 Atwood Stephen A, insurance and real estate.
 Baldwin Mrs R B, milliner.
 Ball Mrs Rosa B, restaurant.
 Barclay G D, justice of peace.
 Blanchard A Dennis, gunsmith.
 Bouford Henry, coal.
 Bradish A B & Co, lumber and builders' hardware.
 Brown Mrs H G, boarding house.
 Brown M L & Co, flour mill.
 Brown & Bigger (J B Brown, L A Bigger), real estate.
 Burrell & Talbot (A K Burrell, J B Talbot), grocers.
 Calverly Richard, boots and shoes.
 Carpenter George W, livery.
 Carr W B, propr Windsor Hotel.
 Carter I M, carpenter.
 Cathcart S B, carpenter.
 Chambers Charles C, propr Reno House.
 Chilver Frederick, carpenter.
 Chrisman Francis R, books and stationery.
 Christenson John, blacksmith.
 Clymer John, physician.
 Clymer John V, lawyer.
 Colee Charles, harnessmaker.
 Courtney James, restaurant.
 Crawford S C, restaurant.
 Crosby Edwin P, veterinary surgeon.
 Decker Belle, grocer.
 Decker & Chamberlain (T J Decker, W Chamberlain), meat market.
 Demuth J M, merchant tailor.
 Devier & Blackburn (W C Devier, J F Blackburn), druggists and grocers.

De Witt Edwin M, blacksmith.
 Dice Hiram W, machine shop.
 Dickey Albert B, druggist.
 Dorman S M, carpenter.
 Duncan F & Co (F Duncan, M J Jordan), grocers.
 Easley Ralph M, propr Hutchinson News.
 Elliott E W, county commissioner.
 Ellsworth A, nursery.
 Evarts E, county commissioner.
 Fishback M L, photographer.
 Frees J A, grocer and crockery.
 George & Mauritzius (J S George, J H Mauritzius), general store.
 Goldberg Isaac, general store.
Grayson Joseph A, Hay, Grain, Live Stock, Farm Implements and Broom Corn.
 Gregg John A, veterinary surgeon.
 Gregg & Shahan (E H Gregg, J N Shahan), hardware.
 Guessaz Louis, jeweler.
 Hale & Co (M and D P Hale), coal, grain and junk.
 Hamlin —, wagonmaker.
 Hardy E S, clerk district court.
 Hardy George W, farm implements.
 Harpole Andrew, feed stable.
 Harsha J M, county surveyor.
 Hartshorn Jacob C, blacksmith.
 Hegwer Henry, grocer.
 Hern J F & G T, meat market.
 Hess David, restaurant.
 Higley Artemus J, lawyer and justice.
 Hosea James W, general store.
 Houk, Brown & Zimmerman (L Houk, W R Brown, S B Zimmerman), lawyers.
Howard House, D W Stimmel Propr. (See adv, p 493.)
 Hubbard & Co (L F Hubbard), grain dealers.
 Hutchinson Herald (weekly), A R Scheble propr.
 Hutchinson Interior (weekly), J W Kanaga propr.
 Hutchinson Lumber Co, James St John mngr, lumber, sash, doors and blinds.
 Hutchinson News (weekly), R M Easley propr.
 Hutchinson W E, propr Gunnison County Mining Co.
 Innes A W, general store.
 Irwin A, saddlery hardware.
 Jackson Mrs T H, photographer.
 Jewell E L, county supt of schools.
 Jordan A P, sberiff.
 Kanaga J W, propr Hutchinson Interior (weekly).

492 HUT	KANSAS STATE GAZETTEER HUT	HUT AND BUSINESS DIRECTORY.	HUT 493
Kansas Lumber Co, B A Colville mngr, lumber and hardware.	Kansas Protective Union , E V Peirce Pres, M S Scott Sec, Offices Wilcox Block.	Rowe Charles H, barber.	Ruddy Martin J, furniture and undertaker.
Kiff G B & Co (G B Kiff), hardware.	Labuhn Fritz, shoemaker.	Ryde Frederick, baker.	Ryde & Freeman, painters.
Latham V B, livery.	Leeman James H, boarding.	Ryther James, mason and marble worker.	Sanders George, barber.
Leidigh T F & Co (T F Leidigh, J M Brehm), grocers.	Lewis W H, county attorney.	Sanders Michael, harnessmaker.	Sanders M & Co, harnessmakers.
Lewis & Beatty (W H Lewis, H W Beatty), lawyers.	McClurg Joseph H, live stock.	Schaffer Allen, city marshal.	Scheble A R, propr Hutchinson Herald.
McCulloch John, grain dealer.	McFarland David T, speculator.	Scheble & Reeder (A R Scheble, J G Reeder), lawyers.	Scott M S , Insurance.
McKee David, coal.	McKee David B, physician.	Sexton —, agent Adams Express.	Sharp Mortimer L, grocer.
McKinney A W, physician.	McKinstry James, lawyer.	Shockley Rev H M, (Presbyterian).	Sillinger Samuel H, physician.
McMurray H, shoemaker.	Maltby Albert P, blacksmith.	Smith Fay, constable.	Smith Simeon C , Wholesale and Retail Dealer in Clocks and Organs, Musical Instruments and Sheet Music.
Marshall W R, county clerk.	Martin John H, tailor.	Smith & Long (Fay Smith, Bud Long), livery.	Stimmel Daniel W , Propr Howard House. (<i>See adv.</i>)
Meyer Eugene L, druggist.	Mincer Abraham, general store.	Sutton Rev John G (Methodist).	Switzer A M, nursery and county commissioner.
Moffet Albert H, railroad and express agent.	Mulkey & Co (W F and J M Mulkey), grain and live stock.	Taylor C & Son (C and R E), general store.	Temple James & Co (James Temple, —), farm implementa.
Myton Clarence B, flour mill.	Newton Wm A, carriage maker.	Templer T J & Co, grain dealers.	Tucker Rev E B (Baptist).
Patchen Charles W, confectioner.	Payne John, register of deeds.	Tucker George F, dentist.	Welsh John, grocer.
Plank Ainos S, jeweler.	Post Rev A H (Baptist).	West, Allison & Co (A M West, M E Allison, Charles Bloom, W C Devere), flour mills.	White Mrs L M, milliner.
Raff Bros (Hiram and S F), dry goods.	Raff's Opera House , Hiram Raff Manager and Postmaster.	Whiteside & Campbell (H Whiteside, R A Campbell), lawyers.	Wilcox Edward, hardware.
Rainsever Christian, restaurant.	Randle Edward M , Coal, Grain and Produce Shipper.	Wilcox Josephus P, photographer.	Williams E E, physician.
Redhead James F & Co (J F and T M Redhead), bankers.	Reeson Joseph, sale stable.	Windsor Hotel, W B Carr propr.	Winslow W L, dentist.
Reno House, C C Chambers propr.	Reno County State Bank (capital \$24,000, surplus \$5,000), I T Hosea pres, S W Campbell cashr.	Winslow & Allbright (C D Winslow, L H Allbright), drugs.	Winters George H, wagonmaker.
Rich Wm R, boarding.	Richards Rev S W (Methodist).	Wolcott Josiah C, livery.	Wolfersberger Isaac, auctioneer and hotel.
Ricksecker Garret V, lawyer.	Robertson N T P, physician.	Woodard George A, confectioner.	Young Bros (L B and E H), boots and shoes.
Rogers A C, meat market.	Rosan & Co (J H D Rosan, Henry Musick), real estate.	Young John H, druggist.	Zimmerman Samuel B, probate judge.

MARY MC CAFFERY, PIONEER WOMAN
by Nadine Showalter

In the year 1863, Mary Casey immigrated from County Cork, Ireland, to New York. She was sixteen at the time. She spent the next ten years doing domestic work in New York. In 1873 she married William Boyle, also a native of Ireland and they decided to move to Kansas and homestead a farm.

Together they had \$140.00 so he took \$70.00 and started to Kansas. She stayed in New York waiting until he found a place for them in Kansas. He rode the railroad to the end of the line which was then East of Independence, Kansas. There he purchased a horse and started riding West and Northwest. He traveled on the Osage Mission Road and his first night near Cherryvale he stopped for the night at the Bender Inn.

The Bender Inn was run by a family which consisted of the father, mother, son and one daughter. Kate, the daughter, was known locally as one who read palms, held seances, and dealt in witchcraft. She was very bewitching as far as men were concerned and when a man stopped there to eat she sat opposite him at a big long table and kept his attention while he ate. Behind him was a curtain and as he ate, Mr. Bender and his son went behind the curtain, hit him in the head with a sledge hammer. They then opened a trap door so that he fell into a cellar under the house. They slit his throat, took his money, and buried him behind the house.

Mary waited about two months in New York and since she had last heard from him near Independence she bought a train ticket to that town. Her searching was in vain until a noted man named Dr. Edward York disappeared in the same vicinity. His brother, a Colonel in the United States Army searched until he found the bodies behind the Bender home. The Benders disappeared in the middle of the night and to this day no one knows for sure what happened to them. The bodies of seven men and one little girl were found in the orchard behind their Inn, one of them being William Boyle.

Mary knew only one person in the vicinity of Independence. He was John McCaffery, a distant cousin whom she had known in childhood in Ireland. Two lonely people, they soon married and started a quest for her dream of a home. They found what they were looking for fourteen miles South of Hutchinson in Castleton Township on the Ninnescah River where they homesteaded land given to them by the railroad.

To this marriage were born five children, Kate in 1875, Mayme in 1876, Ben in 1878, John in 1881 and Jim in 1884. The husband and father died in 1889 leaving Mary with five children to raise on the prairie. The two oldest were girls and the boys ranged in age from five to eleven. Women in those days were of necessity determined or else they didn't survive. Her only weapon against people who bothered her was a blacksnake whip at which she was an expert. It was always just inside her door and many a time it brought a man off of his springboard wagon helpless. The boys learned early to do the farming with horses and they managed to keep the family together somehow.

The last years of her life she suffered severely from sciatic rheumatism and walked with a cane. She died in the house in 1916 where she and her husband had homesteaded forty years earlier.

There has always been a descendent living in the original house they built on the homestead. Jim and his wife lived there with Mary the mother until her death. They continued living there until Jim's death in 1937 when their daughter and her husband Jack Maloney moved in with Jim's widow Nora. Nathalie, the daughter, died in 1973 and Jack died in 1982. The present resident is Michael Maloney, a great grandson of the original homesteaders.

There are only seven granddaughters remaining: Thelma Johnston of McPherson, Anita Fry of Little River, daughters of Mayme; Yozelle Unruh and Isla Hunter both of Hutchinson, daughters of Kate; Jean Cottrell of Helena, Montana and Beryl Woods of Colorado Springs, Colorado and Nadine Showalter of South Hutchinson, daughters of John. Ben never married. The name of McCaffery ran out as there were no grandsons to carry it on.

QUERIES

Would like to know what became of the family of Charles W. HAWKINS, died in Hutchinson, KS (date unknown). Had a dau., Mary, who m. a Mr. VETTER and lived in Hutchinson about 1940. Rollie L. CAMPBELL, 14022 Yelm Hwy S.E., Yelm, WA 98597.

Is there anyone in your Society working on the William EWING and Elizabeth D. (FRENCH) BURNS family? Do you know of any descendants living in the area? I will gladly exchange information if anyone is interested. Mrs. Dale WORKMAN, P.O. Box 57, Stockport, Iowa 52651.

Does anyone know where Dick BROADWELL is buried? He was a member of the Dalton Gang. Killed in the raid on Coffeyville, 5 Oct 1892, he was taken to Hutchinson by relatives and buried here. Other Dalton Gang members killed were Bob DALTON, Grant DALTON, and Bill POWERS. They are buried in Elmwood Cemetery at Coffeyville. James F. TIPPE, Box 2388, Hutchinson, KS 67504-2388, Phone 665-5277.

Philip R. FREIMANN is compiling information on the names of BLAISDELL/BLASDEL and WHIPPLE. He would like to get in touch with or correspond with BLASDELS and WHIPPLES living in Reno County or the surrounding area. Philip R. FREIMANN, 110 Mayfair Drive NE, Leesburg, VA. 22075.

Needed: Information on J.L. HARRISON. He was born Jerome L. HALDEMAN on 14 July 1853 in Evendale, PA., but changed his name to J.L. HARRISON and came to Kansas after 1897. Mr. HARRISON was a pharmacist and his wife's name was probably Ida. Perhaps he died at Hutchinson, KS, between 1915 and 1925. Philip R. FREIMANN, 110 Mayfair Drive NE, Leesburg, VA 22075.

I would like to correspond with any of the descendants of Mrs. Jess WHITE or Mrs. Leslie HARMS living in the Hutchinson area. Mrs. Nyla M. AKIN, 2252 West Drake St., Bolivar, MO 95613

WANTED! DEAD or ALIVE. Information on the whereabouts of any or all of the following men, all former Reno County sheriffs: A.P. JORDAN, John Lafayette "Fay" SMITH, John Q. PATTEN, and George M. DUCKWORTH. All served as sheriff in the period between 1880-1910. No record as yet found shows Reno County as their final resting place. Jim POTTER, P.O. Box 1172, Hutchinson, KS 67504-1172.

HILL: Interested in contacting descendants of John M., Wesley, Henry H., or Benjamin HILL, all born 1828-1840, Floyd County, KY. Parents were Spencer HILL, b. VA; Lucy RAMSEY, b. ca. 1799, VA. These brothers of my ancestor Edward Prebble HILL (b. 1820, d. 1854, Floyd Co., KY) were thought to have emigrated to Reno Co., KS, after the Civil War. Will pay postal and copying costs. Caroline HILL COLEMAN, 1701 N.W. 24th St., Gainesville, FL 32605.

Ralph M. WEFEL, Chairman, Wefel Family Assn., is gathering data for a future book called "Wefel Family Across the U.S.A." Henry John and Anna (HINZE) WEFEL lived in Hutchinson about 1883-1892. His parents were Johann Heinrich and Welhelmina (KLEINSORGE) WEFEL who were born in Germany and lived at Fort Wayne, IN. Interested in any information, old pictures or photographs of the family. Ralph M. WEFEL, 114 Fontana Drive, Oxnard, CA 93033.

=====

ARLENE EAKLE IN WICHITA

Arlene Eakle is coming to Wichita! Watch for date and topic announcement in the next issue.

NEWS FROM THE PAST

(Copied by Delma ASHCRAFT)

Hutchinson Examiner--Thursday, May 25, 1876
Home News

Bertie, infant son of Rev. J.W. and Mrs. L.N. Fox died on Sat. morning last from the effects of a snake-bite. The little child was playing in the yard, when a snake came from a hole in the ground and bit him. At the time no one was home but Mrs. Fox, she did all she could to save the child's life, but her best efforts were in vain. After lingering for a short while in pain the spirit of the loved one fled to a better and happier land. The funeral services were had at the M.E. Church on Sunday last, sermon by Rev. B.C. Swartz.

The Foote Bro's whose place is about two and a half miles from the city, have captured and are taming a lot of wolves, which they caught a few days since, on the prairie, near their house. They begin to look quite domestic.

During the storm Friday night last, lightning struck the pig pen of Mr. Burkhart, setting it on fire, and stunned the occupants. Mr. B. thinks they will recover.

The Hutchinson Silver Cornet Band has improved wonderfully in its playing. We doubt the existence of a band in the State of Kansas which can produce better music than this one. The band is now about six months old and during this time it has played for several balls and entertainments at different points in the State and has invariably given satisfaction and received complimentary notices from the different presses. It is composed of fifteen players: E. Wilcox, leader; J.B. Nash, J.M. Murry, B. Wilcox, Chas. Tucker, Dr. Sidlinger, Mr. Winslow, G. & L. Mead, H.S. Fitch, R. Adamson, and others constitute the band of which our city is justly proud.

News cont.

Died--At the Drug Store of (Mssrs) Winslow & Albright, last week. A rattlesnake, the property of the above names firm. Sorry to record such calamities.

List of letters remaining uncalled for at the post office at Hutchinson, Kansas, May 23, if not called for in four weeks, will be sent to the dead letter office.

Gibbons, Wm. G.
Harding, J.W.
Jones, C.J. (?)
Lovell, Joseph B.
Lawson, James II
Short, Levi
Sagher, G.B.
Wilson, W.H.
Weldy, D.H.

Held for postage: Mrs. William Pierce, Highlandtown, Ill.; Louis Halburt, Cottonwood Falls, Kansas.

Persons calling for these letters please say "advertised." E. Wilcox, P.M.

Hutchinson Examiner--Thursday, June 1, 1876
Home News

Jno. Putnam, Wm. Poulton, Chas. Farley, Geo. W. Carpenter, Joel Reger, Jas. Crow, A.M. Stanfield, Thos. Bayle and Chas. Collins of the Hutchinson, P.O.E. Craig Livingston O. are the names of subscribers so far this week who have attached their names to the list of the Examiner.

H.E. England, a carpenter of experience, would respectfully announce to the citizens of Hutchinson and Reno County that he has permanently located, and desires a share of the public trade.

Died--On Tuesday last, after a protracted illness, Mrs. Teeters, in the _____ year of her age.

News cont.

List of letters remaining uncalled for at the P.O. at Hutchinson, Kansas.

Willman, Heinrich
Potter, William
Walters, Francis M.
Weger, Mrs. Louisa
Williams, Lant
Wright, E.

Hutchinson Examiner--Thursday, June 8, 1876
Home News

Born--In Westminster on the 27th inst. a Centennial Gagnuen. Weight 13½ lbs. Mother and child doing well. (Note from Delma Ashcraft: I was curious as to what "A Centennial Gagnuen" meant. With the help of Bert Newton, I found in the Reno County Cemetery Book: Samuel Gagnebin, b 26 May 1876; d 16 Mar 1967.)

List of letters remaining uncalled for:

Campbell, James M.
Dander, Lewis
Findly, J.R.
Gerrid, Reuben
Horton, A.B.
Knight, L.
Mason, Robert
Moore, Miss Mary I.
Miskin, James
Powers, Charles H.
Pierce, W.S.
Taylor, Mill Minnie E.
Young, Thomas

THANK YOU, ARLESS EILERTS

Pam and I would like to thank Arless Eilerts for the articles she wrote for **THE SUNFLOWER** that you will read in this issue.

We are finding out how much time you donated to the Reno County Genealogical Society as Editor of **THE SUNFLOWER**. Just because you are no longer the editor, don't let that stop you from contributing articles or suggesting ideas for future stories.

Thanks again, from Pam and I and all of the members of the RCGS. RHF

Copying Photographs

W. C. Weaver, Exchange Chairman, The Houston Genealogical Forum, suggests the following technique for improving the quality of photographs copied on a photocopy machine. Credit is given to the Mesquite, Texas G.S. and the Boulder G.S.

"When copying photographs on the photocopy machine, the quality can be improved by using a copy-screen. Copy screens are available in the 65 line and 85 line sizes. Use of the screen (under the photo being copied) creates a dot matrix image and produces a copy with better detail and contrast balances. Such screens are available for around \$3.25 from larger art supply stores."

W. C. Weaver reported testing this technique with a 65 line copy-screen with photos from 1930 in black and white and from 1987 in color print. "Xerox type copies were made before using the screen; then the screen was laid on the glass, rough side up; the pictures laid face down on the screen; and a copy was made. The difference in the two copies is worth the small cost of the screen which can be kept and reused many times." (Source: Illinois State Genealogical Society Newsletter, Springfield, ILL., Feb. 1989 which credited The Genealogical Record, published quarterly by the Houston Genealogical Forum. Submitted by Betty MORGAN.)

(Editor's note: If you are doing photos for further reproduction, perhaps for a family history to be printed, you may want to investigate having a printer make PMTs (or Veloxes) for you to use. Pictures of the same contrast can be "ganged" (several screened at one time) thus saving money. The printer can also reduce or enlarge photos if the pictures are screened individually. The quality of these is considerably better than the ones which use the copy-screen.)

"Graves Give and Take," a new newsletter about GRAVES family lines will start publication this year, quarterly, first issue August 1989. Interested persons are asked to share GRAVES family information. \$10 annually. Pat Moore Publications, 111 Ardmore Drive, Billings, MT 59102.

Turon High School Graduates

(Editor's note: The names of Turon High School's graduates, continued from the November 1988 issue, come from the 1987 alumni booklet provided at the annual reunion of the students graduating through 1962, the last class of Turon High School before it became part of Fairfield.)

1939

ORTHA ADAMS (deceased)
 CARL COMPTON Turon, KS 67583
 LOIS CROTTS (GEESLING) (deceased)
 RUTH DAUTRICH (GADBURY) 3815 W. 8th,
 Wichita, KS 67203
 PAULINE EDWARDS (DURHAM) 2020 Walnut,
 Harper, KS 67058
 HELEN FOREMAN (GRAY)
 CLIFFORD JONES 3240 S. Mt. Carmel,
 Wichita, KS 67217
 MAXINE KIRKHUFF (LITCHFIELD)
 Sylvia, KS 67581
 JANE LAMONT (BAUMAN) Turon, KS 67583
 PAUL LAMONT 4302 Windy Hill Road,
 Decatur, AL 35603
 LLOYD LAUGHLIN (deceased)
 WILBUR MILLSPAUGH
 BURL PADGETT (deceased)
 JIM SHIVE 2136 Hibiscus St.,
 Sarasota, FL 33579
 ARDIS SNEDECOR (TUBBS) 1509 S. Main,
 Blackwell, OK 74631
 ETHEL STULL (SAUNDERS) 3139 S. Ogden,
 Englewood, CO 80110
 LOIS THOMAS (MILLER) Rt. 1,
 Winfield, KS 67156
 BOWIE TUBBS 1509 S. Main,
 Blackwell, OK 74631
 EARL WELCH 1615 Center Ave.,
 Hutchinson, KS 67501
 KEITH WELCH Turon, KS 67583
 RUTH ZINK (GRABER) (deceased)
 BERTHA ZONGKER (THOMAS) Turon, KS 67583

1940

LYLE BARTHOLOMEW (deceased)
 DON BURNETT Turon, KS 67583
 UYVONNE DIMMITT (FORNWALT) (deceased)
 ROLLA DURHAM Turon, KS 67583
 ROGER FULKS Turon, KS 67583
 WARREN GEESLING Turon, KS 67583
 ANN GORHAM (ZINK) Turon, KS 67583
 BILLIE HAGAN (BUMGARNER)
 BERNICE KITSON (EDWARDS) 1914 Adams St.,
 Everett, WA 98203

MANUEL KITSON 207 Hawkins,
 Penrose, CO 81240
 MARY LOWE (BATOZECK) 3802 Canal Road,
 Joliet, IL 60436
 VELMA MCCOULLOUGH (SCOTT)
 Preston, KS 67569
 LEO MATHEWS (deceased)
 ESTHER PADGETT (DUNCAN)
 FRANK PETERSON (deceased)
 RALPH SCHLOTTER
 LORRAINE SCHMIDT (POLLARD)
 RICHARD TEGARDNEN Box 9300, Dept. 1,
 Minneapolis, MN 55440
 ALLAN THOMAS Turon, KS 67583
 WILLIAM WESTFAHL Turon, KS 67583
 VIRGIL E. ZINK, JR. Turon, KS 67583

1941

PAT BOEN (HARVEY)
 VERNON COMPTON (deceased)
 ROY COOK 612 N. 38th St.,
 Woodward, OK 73801
 VIRGINIA EDWARDS (WELCH) 1615 Center Ave.,
 Hutchinson, KS 67501
 DARRELL MC OSKER 3906 Baltimore, Apt. 411,
 Kansas City, MO 64111
 ROBERT MILLSPAUGH (deceased)
 OPAL NELSON (HARTWIG) Rt. 1, Box 57,
 Plainville, KS 67663
 EVELYN SLATER (MESSERLI) 512 Atkinson Dr.,
 Midwest City, OK 73110
 DOROTHY SCHMIDT (WAGNER) 1423 N. High,
 Wichita, KS 67203
 HELEN SMITH (HART) c/o Gerturde Fortner,
 1332 S. Vine, Wichita, KS 67213
 BETTY WATSON (LAUGHLIN) 303 Jefferson,
 Centrailia, WA 98531

1942

MARGARET BRANSCOM (DYKES) 5314 Eisenhower,
 Great Bend, KS 67530
 RUTH ANN BOLES (KOEHN) Box 313,
 Cimarron, KS 67835
 WARD COMPTON (deceased)
 JOHN COLE 2510 Tyler, Hutchinson, KS 67502
 MARGIE COPELAND (KITSON) 205 W. 25th,
 Hutchinson, KS 67502
 HAROLD CROTTS Turon, KS 67583
 LLOYD DAUTRICH 3815 W. 8th,
 Wichita, KS 67200
 GLENDA EBERHARDT (ADAMS) 3610 Butterfield
 Lane, Joplin, MO 64801
 CLAUDE ELLIOT Rt. 2, Box 76,
 Ellinwood, KS 67526
 DALE EVANS Arlington, KS 67514

ELLA FALL (DICKERSON) 741 N. 2nd,
Lindsborg, KS 67456
MURIEL FULKS (RAINES) Box 237,
Limon, CO 80828
ELIZABETH HANSON (ZINK) Turon, KS 67583
EVA HAZEN (BURHENN) 2816 W. Randolph,
Enid, OK 73701
FORD KITSON (deceased)
JOE LAMONT (deceased)
ROSEMARY LAUGHLIN (TADE) 9318 Willowview,
Houston, TX 77055
BENNIE LENAGAR (deceased)
DAVID LOWE 362 Zink Ave.,
Santa Barbara, CA 93111
CECIL MC ELEHANEY 1751 Kentucky,
Redwood City, CA 94061
PHYLLIS MELTON (VANN) (deceased)
MARIE PEDERSON (REEVES) 1918 Crestline Dr.
Winfield, KS 67156
MELVIN PEDERSON 2413 W. 24th,
Topeka, KS 66611
JOHN TILLEY
BONNIE TOLBERT
JESSIE LOU TUBBS (FLETCHER) 1401 S. Main,
Wichita, KS 67213
DALE WELCH 711 W. 19th,
Hutchinson, KS 67502
DONALD WELCH c/o Orlo Welch, Box 29,
Florence, CO 81226
CLEO ZINK (BRANNAN) Box 13, Meade, KS 67864

1943

RUTH ELLIOT (BARBOUR) 611 W. 2nd,
Pratt, KS 67124
CAROL BARTHOLOMEW
JOAN CARMICHAEL (JONES) 1658 N. Estelle,
Wichita, KS 67218
TOM COATS (deceased)
WILMA JEAN CROTTIS (BOILEAU) 3912 Wosley Dr.
Fort Worth, TX 76133
SAM GORHAM JR. 417 W. Aspinwall,
Winslow, AR 86047
ALVIS KIRKHUFF (HUGHES) 176 Rutledge Dr.,
Red bank, NJ 07701
ELLIS LLOYD KITSON (deceased)
JIM LINDER (deceased)
RUTH ANN PEDERSON (GADBURY) Turon, KS 67583
PHILLIP SHANLINE 917 Golfview Court,
Rochester Hills, MI 48063
MELDA SMITH (DEVANEY)
JIM SNEDECOR Rt. 1, Dodge City, KS 67801
MARY ANNA STINEBURG (CUNNINGHAM)
Turon, KS 67583
EVA MAE STULL (HURST) 2131 N. Clay,
Topeka, KS 66608

WILMA JEAN TOPE (CLEMMENTS) 3415 N. Waldron
Hutchinson, KS 67502
MAX TOOLEY 11018 Genetta Dr.,
Dallas, TX 75228
CATHERINE TUBBS (GARNER) 7873 Bahia Vista
Court, Jacksonville, FL 32216

1944

ELIZABETH BARGDILL (EVANS)
Arlington, KS 67514
HAROLD CUNNINGHAM Turon, KS 67583
VIOLA FUNDENBURG (PERKINS) 209 W. Ave. B,
Hutchinson, KS 67501
EILEEN HAZEN (FRANK) Turon, KS 67583
STRATTON HERMANN 4301 Saturn Way,
Chandler, AR 85224
JOYCE HODSON (LAKIN) Box 244,
Raymond, NH 03077
PHYLLIS LAMONT (BURNETT) Turon, KS 67583
LOIS MARCUM (WALTERS) 1013 Lincoln,
Emporia, KS 66801
MARION J. RAINES Box 237, Limon, CO 80828
ARGLE SCHMIDT (MAUCK) Rt. 1, Box 26,
Limon, CO 80828
RIX SHANLINE 2406 Rebecca Road,
Manhattan, KS 66502
JESSICA SHIVE (GATZ) Preston, KS 67569

1945

JANE ALTHAUS (NICKELS) Plevna, KS 67578
LAVERNA COOPER
DON CUNNINGHAM 515 W. Claflin,
Salina, KS 67401
OLGA DURHAM (TUCKER) Rt. 1, Box 36,
Elkhart, KS 67950
ALVIN ELLIOT 404 University Ave.,
Dodge City, KS 67801
DUANE FOULK 105 Balfour,
Colorado Springs, CO 80907
JOYCE HANSEN (SHAFFER) 8633 W. 90th Terrace
Overland Park, KS 66212
PHYLLIS KIRKHUFF (PHILLIPS)
MILDRED LENAGAR (BALDWIN) Box 151,
Cawker City, KS 67430
BARABARA NELSON (MEIREIS) Turon, KS 67583
JUNE SHRUM (BRYAN) 1630 E. Drive,
Bartlesville, OK 74006
BETTY STULL (HOWARD) 3670 Termont Dr.,
Florissant, MO 63033
BILLY TAYLOR c/o Bedford Taylor,
Grove, OK 74344
DALE TEGARDEN Turon, KS 67583
BILLY VAN TUBBS 1825 N.E. 159th,
Portland, OR 97250
BILLY WATSON (deceased)

ITEMS FOR SALE

CEMETERY RECORDS OF RENO COUNTY
 Burials from 1860's through 1978. \$20 plus \$1.75 postage and handling. Kansas residents add \$1.25 sales tax.

EARLY MARRIAGE RECORDS OF RENO COUNTY
 1872 - 1913. \$20 plus \$1.50 postage and handling. Kansas residents add \$1.25 sales tax.

1880 CENSUS RENO COUNTY, KANSAS NEW!
 \$15.00 plus \$1.50 postage and handling. Kansas residents add \$.95 sales tax.

GUIDE TO RENO COUNTY RECORDS \$1.50
 SURNAME FILE INDEX 2.50
 1985 SUPPLEMENT (to above index) 1.50

CHARTS:

Ancestor chart .05
 Census worksheet .05
 1790,1800-10,1820,1830-40,1850,
 1860-70,1880,1900,1910
 Family chart .05
 Additional Children sheet .05
 Vital Records Application .05
 Federal Census Searched sheet .05
 Census worksheet packet (10) .50
 Additional Children packet (10) .50
 Family Chart packet (20) 1.00
 Ancestor Chart packet (20) 1.00
 15-Generation Ancestor Chart 1.25
 RCGS Note Pads--ruled, unruled 1.00
 RCGS Pencils .25

(Add \$1.00 postage and handling for each item ordered over \$1.00.) Kansas residents add 5.75% sales tax. Send orders to: RENO COUNTY GENEALOGICAL SOCIETY, P.O. BOX 5, HUTCHINSON, KS 67504-0005.

ANNOUNCEMENTS

If your ancestor was a doctor, you might try the Division of Library and Archival Services, American Medical Assoc., 535 N. Dearborn St., Chicago, IL 60610.

Are you looking for a rare county or family history book? The Allen County Public Library, 900 Webster Street, Fort Wayne, IN 46802, will check their holdings for a title and copy it (if out of copyright) for \$.15 per page plus \$3.00 handling fee. Binding extra.

When you are looking for a state's census, remember that some states were at one time part of another state or territory. For example, the 1820 and 1830 Wisconsin census records are with those of Michigan. The 1860 Colorado census is with the Kansas census. The 1860 Wyoming census is with those of Nebraska. The 1860 Nevada census is in with Utah and the 1860 Oklahoma census is with Arkansas which was then Indian Territory.

Connecticut Society of Genealogists, Inc., Nov/Dec 1988. Copied by RCGS member Arlene Vincent.

1850 Census, not index, can be bought on microfilm from S-K Publications, P. O. Box 8173, Wichita, KS 67208. Write for price list.

THE SUNFLOWER, a quarterly publication
 Pam (THOMPSON) STANSEL, Editor
 Ruth (HAIR) FILBERT, Editor
 P. O. Box 5
 Hutchinson, KS 67504-0005

Non-profit Organization
 U.S. Postage Paid
 Hutchinson, Kansas
 Permit No. 171

ADDRESS CORRECTION REQUESTED

RENO COUNTY GENEALOGICAL SOCIETY
INDEX TO VOLUME XI NUMBER 1, 2, 3, & 4

A					
ADAMS	38			CROONS	16
ADAMSON	36	BRANSCOM	38	CROSBY	32
AKIN	35	BRAY	10	CROTTS	10,38,39
ALBERT	16	BRAZEE	20	CROW	36
ALBRIGHT	36	BREAVER	16	CULVER	2,22
ALDRICH	24	BREHM	33	CUNNINGHAM	39
ALLBRIGHT	33	BREM	24	CURRAN	27
ALLISON	33	BRESSLER	10	CUSHING	2,22
ALTHAUS	39	BROADWELL	35		
ANDERSON	24	BROWN	5,8,9,20,32	D	
ASHCRAFT	21,36,37	BULLARD	9	DALTON	35
ATKINSON	32	BURGESS	2,16,22	DANA	10
ATWOOD	32	BURKHART	36	DANDER	37
AUSTIN	24,27,28,29	BURKHOLDER	9	DAUGHMAN	10
AVERY	16	BURLING	5	DAUTRICH	38
AYRES	11	BURNETT	38	DAVIS	10
		BURNS	35	DE WEESE	5
		BURRELL	32	DE WITT	32
				DEAKS	16
B		C		DECKER	32
BAILEY	20	CALKINS	10	DEMUTH	32
BAIRD	24	CALVERLY	32	DEVERE	33
BALDWIN	32	CAMPBELL	27,33,35,37	DEVIER	32
BALL	10,27,32	CARMICHAEL	39	DICE	32
BARCLAY	32	CARPENTER	32,36	DICK	15
BARGDILL	39	CARR	32,33	DICKEY	32
BARKER	20	CARTER	32	DIMMITT	38
BARNARD	16	CASEY	34	DOTY	5
BARNETT	5	CATHEART	32	DUCKWORTH	35
BARR	10	CHAMBERLAIN	32	DUNCAN	32
BARTELSON	27	CHAMBERS	32,33	DUNWORTH	16
BARTHOLOMEW	38,39	CHEATUM	9	DURHAM	32,38,39
BARTON	27	CHILVER	32		
BAYLE	36	CHRISMAN	32	E	
BEAR	15,16	CHRISTENSON	32	EAKLE	35
BEATTY	33	CLARK	20	EASLEY	32
BELLEW	5	CLOTHIER	23	EATON	5
BELTY	16	CLYMER	32	EBERHARDT	38
BENEDICT	27,28	COATS	39	EDWARDS	38
BIGGER	16,32	COLE	10,38	EILERTS	21,23,30,37
BILK	30	COLEAN	9	ELLIOT	5,38,39
BILLS	27	COLEE	32	ELLIOTT	32
BIRCH	27,30	COLEMAN	24,35	ELLIS	27
BIRD	27,29	COLLADAY	20	ELLSWORTH	32
BLACKBURN	20,32	COLLINS	5,36	ELY	5,8,9
BLANCHARD	32	COLVILLE	33	ENGLAND	36
BLOOM	33	COMPTON	38	EPP	16
BLUM	27	COOK	38	ERWIN	20
BOEN	38	COOPER	39	EVANS	27,28,30,38
BOLES	38	COOTER	20	EVARTS	32
BONFORD	27	COPELAND	38	EWING	23,35
BONTZ	24,27,29	COTTRELL	34		
BOUFORD	28,32	COURTNEY	32	F	
BOWER	28	COX	2	FAIR	27
BOYLE	34	CRAWFORD	32	FALL	39
BRADISH	32	CRESSWELL	10	FARLEY	36
BRADSHAW	10,11			FAY	20
BRADY	9			FELL	27
				FICKERTT	27,30
				FILBERT	2,3,4,19,22
					40
				FINDLY	37
				FISHBACK	32
				FITCH	36
				FITZGERALD	10
				FLANAGAN	16
				FLETCHER	20
				FOREMAN	38
				FORNEY	24
				FOULK	39
				FOX	20,36
				FREIMANN	35
				FRENCH	20
				FROES	32
				FRULEN	16
				FRY	16,34
				FULK	9,16
				FULKS	38,39
				FUNDENBURG	39
				FURLONG	15
				G	
				GAGNEBIN	37
				GANO	20
				GARDENSHIRE	8
				GARDNER	2,22
				GEESLING	9,10,38
				GEIST	24
				GEORGE	32
				GERRID	37
				GIBBONS	36
				GILLESPIE	27,29
				GOERZEN	16
				GOLDBERG	32
				GOOD	27
				GORHAM	38,39
				GRABER	23
				GRANVILLE	27
				GRAVES	11,19
				GRAY	18,24,27
				GRAYSON	32
				GREGG	32
				GRIFFITH	20
				GROVER	2.22
				H	
				HACKETT	20
				HADSELL	16
				HAGAN	38
				HALBURT	36
				HALDEMAN	35
				HALE	32
				HALL	9
				HALLOWELL	20
				HAMLIN	32
				HAMMEL	9

HAMMOND	20	JOHNS	16	MANCK	9		O	
HANSEN	39	JOHNSTON	34	MARCUM	39	ONEAL		28
HANSON	39	JOLSON	16	MARDIS	28	OSWALD		20
HARDER	16	JONES	5,8,9,20	MARSHALL	16,33			
HARDING	36		27,36,38	MARTIN	8,9,10		P	
HARDY	32	JORDAN	5,20,32,35		16,33	PADFIELD		20
HARMS	35	JOSEPHSON	27,28	MASON	37	PADGETT		38
HARPOLE	32			MATEER	8,10	PALMER		28
HARRINGTON	16			MATHEWS	38	PANSHAW		16
HARRISON	15,16,27	K		MAUCK	10	PARISH		28
	30,35	KAHN	28	MAURITZIUS	32	PATCHEN		33
HARSBORN	32	KANAGA	32	MAY	9,28	PATTEN		35
HARSHA	32	KEHOE	16	MC CAFFERY	21,34	PAYNE		33
HARTFORD	16	KELLY	20	MC CLURG	33	PAYTON		28,30
HASTY	11	KELMAN	10	MC CLURY	10	PECHIN		9
HAWKINS	29,35	KENNEDY	9	MC COULLOUGH	38	PEDERSON		39
HAWLEY	27,29,30	KENOYER	16	MC COULLAM	28	PEIRCE		33
HAZEN	39	KIFF	33	MC CULLOCH	33	PENNY		20
HEGWER	32	KILMER	8	MC CULLOCH	33	PETERSON	2,22,24,38	
HELMIG	27,29	KING	9	MC ELEHANEY	39	PETRO		20
HENDERSHOT	2	KINLEY	16	MC FARLAND	33	PHILLIPS		16
HERMANN	39	KIRKHUFF	38,39	MC ILLIWANE	16	PICKET		16
HERN	32	KITCHEN	28	MC KEE	33	PIERCE	20,36,37	
HESS	32	KITSON	38,39	MC KINNEY	33	PLANK		33
HICKEY	11	KLINE	20	MC KINSTRY	20,33	PLOUGHE		10
HICKMAN	5	KNIGHT	37	MC LANE	28	PORTER		10
HIGLEY	32	KOONTY	20	MC MUKRRAY	33	POST		28,33
HILL	27,35	KOOP	16	MC MURRY	20	POTEET		8
HINSHAW	24	KRACKENBERGER	9	MC NAGHTEN	20	POTTER		5,35,37
HINTZ	10	KROCKENBERGER	9	MC OSKER	38	POULTON		15,16,36
HITCHCOCK	20			MEAD	36	POWERS		35,37
HODSON	39	L		MELTON	39	PRATHER		20
HOLLAND	10	LABUHN	33	MEYER	33	PRATT		11
HOLLEY	24	LAMONT	38,39	MEYERS	5	PRECIOUS		16
HORRIGON	10	LANG	25	MILLER	2,10,22	PROCTOR		2,22
HORTON	37	LANHAM	10	MILLSPAUGH	38	PUTNAM		36
HOSEA	32,33	LATHAM	33	MINCER	33			
HOTT	27	LAUGHLIN	38,39	MISKEN	37			
HOUK	32	LAWSON	36	MOFFET	33		R	
HOWARD	9	LAYMON	5	MONTGOMERY	9	RAFF		33
HUBBARD	32	LEE	28,29	MOORE	2,37	RAINES		39
HUDSON	23	LEEMAN	33	MORGAN	37	RAMSEY		35
HUMPHREYS	20	LEIDIGH	33	MORRIS	29	RAMSEYER		33
HUNTER	34	LENAGAR	39	MOULDS	18	RANDLE		33
HURD	27	LEWIS	33	MULKEY	33	REDHEAD		33
HUSTON	16	LINDER	39	MURPHY	2,22	REEDER		33
HUTCHINSON	20,32	LITCHFIELD	24,28	MURRAY	9,10	REESON		33
HUTTON	20	LITTLEFIELD	28	MURRY	36	REGER		36
		LIVINGSTON	36	MUSICK	33	REGHER		16
		LONG	10,23,33	MYTON	33	RICH		33
		LONGSHORE	16			RICHARDS		15,16,28,33
		LOTTTRIDGE	28,30		N			
		LOVELL	36	NASH	36	RICKENBRODE		15
		LOWE	38,39	NELSON	22,24,38,39	RICKSECKER		33
I				NEWTON	22,33	ROBERTS		23,27,28
INGHAM	20			NIBLACK	9,10	ROBERTSON		9
INNES	32	M		NICKEL	16	ROBINSON		23
IRWIN	32	MACKAY	28	NICKELS	16	ROGERS		33
		MALLOY	20	NICOLS	9	ROLAND		11
J		MALONEY	34	NORRIS	28	ROLLAND		11
JACKMAN	20	MALTBY	16					
JACKSON	32	MALTHY	33					
JANES	9							
JENKS	8,9							
JEWELL	32							

ROSAN	33	STEARNS	28	VOARHEES	9
ROSEHERY	10	STEVENS	10		
ROWE	33	STEWART	23		
ROZEL	20	STEWART	28	W	
RUBERT	20	STIFFLER	11	WAGGONER	24
RUDDY	33	STIMMEL	32,33	WAGONER	11
RYDE	33	STINEBURG	39	WAKEFIELD	16
RYTHER	33	STRAHMEYER	16	WALTERS	37
		STREETER	2,22	WARNER	5
		STRIEBEN	16	WATERS	29
S		STULL	38,39	WATKINS	5,10
SAGERTY	20	SULLINGER	33	WATSON	29,38,39
SAGHER	36	SUTTON	33	WEAVER	15,37
SALLEE	10	SWARTZ	36	WEBB	8,9,20
SAMPLE	16	SWITZER	28,33	WEFEL	35
SANDERS	33			WEGER	37
SAUDERS	33			WEIGNER	27,29
SCHAFFER	33	T		WELCH	38,39
SCHEBLE	20,32,33	TALBOT	24,32	WELDY	36
SCHLOTTER	38	TALBOTT	28,29	WELSH	33
SCHMIDT	38,39	TAYLOR	16,20,33	WEST	33
SCHUMAKER	20		37,39	WESTFAHL	38
SCOTT	33	TEETERS	36	WHITE	29,33,35
SEALY	16	TEGARDEN	39	WHITEHURST	24
SEXTON	33	TEGARDNEN	38	WHITESIDE	20,33
SHADDUCK	10	TEMPLE	33	WHITROW	16
SHAHAN	32	TEMPLER	33	WILCOX	33,36
SHANLINE	39	THOMAS	38	WILEY	20
SHARP	33	THOMPSON	23,24,29	WILHITE	23
SHEPHERD	23,24,28	TILLEY	39	WILKINS	9
	29,30	TIPPE	35	WILLIAMS	16,20,33,37
SHIPLEY	9,10	TIPTON	24	WILLISON	28,29,30
SHIVE	38,39	TOLBERT	39	WILLMAN	37
SHOCKLEY	33	TOMLINSON	29	WILLSON	27,29,30
SHORT	36	TOMPKINS	19	WILSON	36
SHORTENKIRK	16	TOOLEY	39	WINSLOW	33,36
SHOWALTER	11,34	TOPE	39	WINTERS	33
SHRUM	39	TRIPLET	29	WOLCOTT	33
SICKMON	10	TRIPLETT	29,30	WOLFERSBERGER	33
SIDLINGER	36	TUBBS	38,39	WOODARD	33
SIMMONS	16	TUCKER	33,36	WOODS	34
SLACK	9	TURMAN	20	WOODSON	10
SLATER	38	TURNER	29,30	WORKMAN	35
SLEEPY	9			WRIGHT	10.16.37
SMITH	16,24,28,33	U			
	35,38,39	ULNER	5	Y	
SNEDECOR	38,39	UNDERWOOD	29	YAPLE	10
SOOTER	10	UNRUH	16,34	YEO	9
SOPER	16			YORK	34
SPENCER	16	V		YOUNG	33,37
ST. JOHN	32	VAN ARSDALE	29		
STAATS	23	VAN EMAN	5	Z	
STAFFORD	24	VAN TUBBS	39	ZIMMERMAN	32,33
STALLCUP	28	VANCE	20	ZINK	38,39
STANFIELD	36	VENDIG	28,29	ZONGKER	38
STANSEL	2,3,11,20	VEST	10		
	22,40	VETTER	35		
		VINCENT	2,16		